



Orchard Drive, Epping, CM16

BUTLER & STAG



Situated in the heart of Theydon Bois is this stunning spacious four bedroom semi detached chalet bungalow, perfectly located for the village shops, pubs and restaurants and around a six minute walk to the Central Line Underground Station.



Freehold

- Semi Detached Chalet Bungalow
- Four Bedrooms/One Bathroom
- Modern Kitchen/Breakfast Area
- Summer House/Garage/Off Street Parking
- Spacious Lounge/Downstairs WC/Utility Area
- Stunning Throughout

The property offers an abundance of living space spanning just over 1620 sq ft. Accommodation consists of a large formal living room, a separate kitchen/Breakfast Area, downstairs WC, utility room which can be made into a fully fitted shower room, bedrooms three and four complete the ground floor.

The first floor you find the master bedroom with walk in wardrobe, the second bedroom, which has good storage, and a family bathroom.

Externally, the property boasts off street parking via the driveway, side access and a mature north-east facing garden. With a separate detached garage which has been turned into half storage, half home office. At the end of the garden, you will find a summer house which is perfect for the kids to enjoy in the summer or the winter.

Orchard Drive is a much sought after turning in the ever-popular village of Theydon Bois. The village is arranged around the green and offers a parade of shops, pubs and restaurants and offers easy access into Epping Forest, with its deer sanctuary. Transport links into London are excellent. Theydon Bois underground station is in walking distance and there are several well regarded state and private schools within easy reach. Local leisure facilities include golf courses, sports centres and a tennis club.





Orchard Drive, CM16

Ground Floor

Approx. 87.98 Sq. meters (947 Sq. feet)



First Floor

Approx. 44.31 Sq. meters (477 Sq. feet)

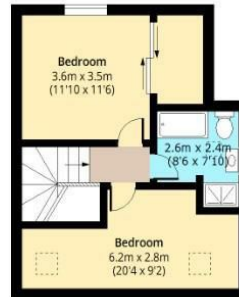

Total area : approx. 152.26 Sq. meters (1639 Sq. feet) (Including Storage/ Garden Room)
Total area : approx. 132.29 Sq. meters (1424 Sq. feet) (Excluding Storage/ Garden Room)
For illustration purposes only - not to scale
www.jpaplus.com

IMPORTANT NOTICE - These particulars have been prepared in good faith and they are not intended to constitute part of an offer or contract. We have not performed a structural survey on this property and the services, appliances or specific fittings have not been tested. All photographs, measurements, floor plans and distances referred to are given as a guide and should not be relied upon.

BUTLER & STAG

☎ 01992 667666

🏠 4 Forest Drive, Theydon Bois, Essex, CM16 7EY

✉ theydon@butlerandstag.com

www.butlerandstag.uk